

SEBASTIAN DARKROOM CASEWORK

WALL CABINETS - SWCO

"SWCO" WALL CABINETS ARE OPEN CABINETS WITHOUT DOORS AND ARE AVAILABLE IN TWO HEIGHTS: 18" AND 30". 18" HIGH CABINETS ARE SUPPLIED WITH ONE ADJUSTABLE SHELF AND 30" HIGH CABINETS ARE SUPPLIED WITH TWO ADJUSTABLE SHELVES.

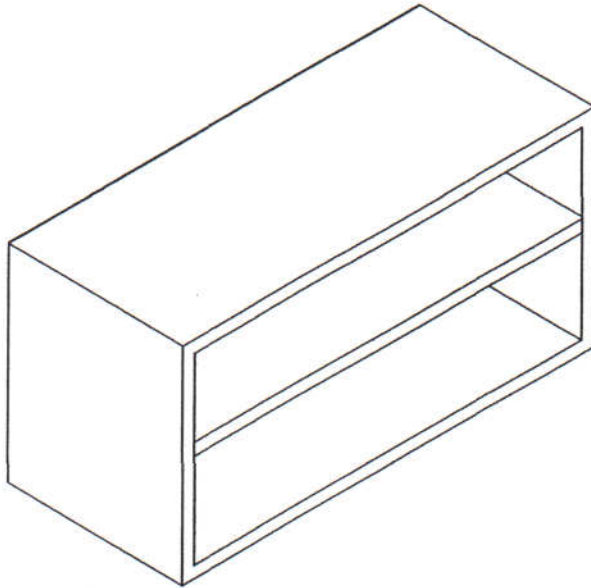

WALL CABINET 18" HIGH

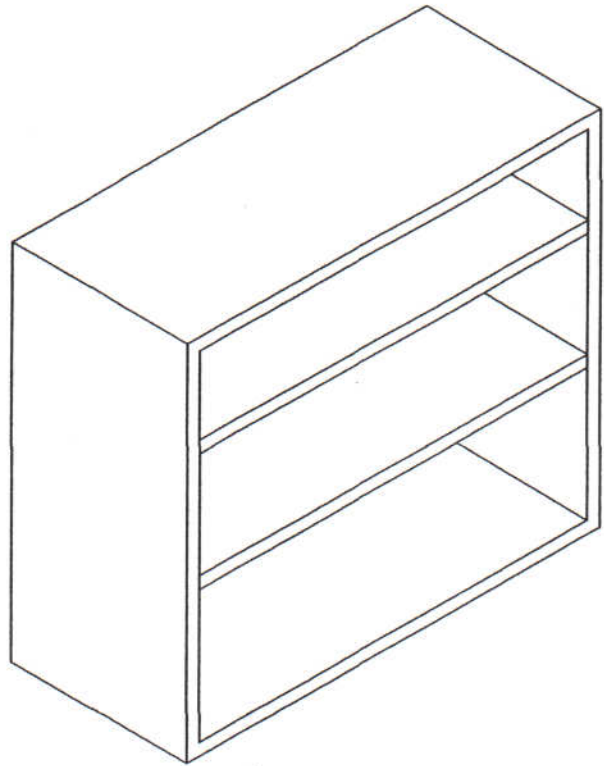

WALL CABINET 30" HIGH

| WALL CABINET MODEL | WIDTH | HEIGHT | DEPTH |
|--------------------|-------|--------|-------|
| SWCO-151812 | 15" | 18" | 12" |
| SWCO-181812 | 18" | 18" | 12" |
| SWCO-211812 | 21" | 18" | 12" |
| SWCO-241812 | 24" | 18" | 12" |
| SWCO-271812 | 27" | 18" | 12" |
| SWCO-301812 | 30" | 18" | 12" |
| SWCO-331812 | 33" | 18" | 12" |
| SWCO-361812 | 36" | 18" | 12" |

| WALL CABINET MODEL | WIDTH | HEIGHT | DEPTH |
|--------------------|-------|--------|-------|
| SWCO-153012 | 15" | 30" | 12" |
| SWCO-183012 | 18" | 30" | 12" |
| SWCO-213012 | 21" | 30" | 12" |
| SWCO-243012 | 24" | 30" | 12" |
| SWCO-273012 | 27" | 30" | 12" |
| SWCO-303012 | 30" | 30" | 12" |
| SWCO-333012 | 33" | 30" | 12" |
| SWCO-363012 | 36" | 30" | 12" |



SEBASTIAN DARKROOM PRODUCTS™ DIVISION OF CALIFORNIA STAINLESS MFG.

Unique, Innovative & Engineered to Work
TOLL FREE (888) 712-7035 FAX (805) 484-1030

calstainless@aol.com

www.sebastiandarkroomprod.com